

Stingray the power to change

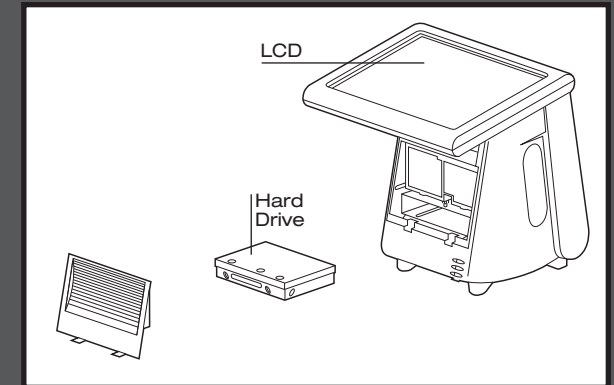
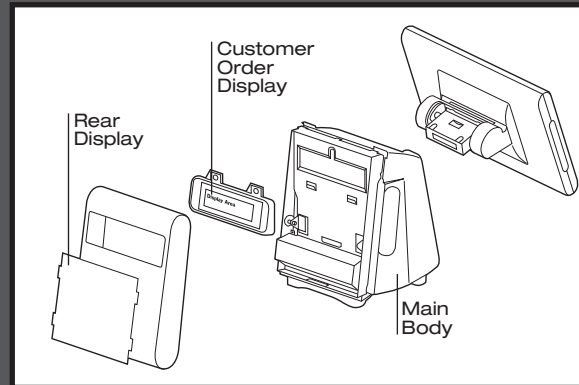

modular design makes service easy and cost-efficient

Stingray's unique modular design greatly simplifies serviceability. Engineered with components you can easily replace yourself, Stingray offers lower total cost of ownership by allowing you to virtually eliminate the time and expense of service calls and service contract fees.

Stingray's LCD display, hard drive, main body, rear display (static or interactive) and 2/4 line customer order display are user-removable and replaceable through the use of conveniently placed thumb screws. It's fast, easy, and cost effective – simply place a sales order for a new module or stock the inventory on your own shelf to virtually eliminate downtime. No service contract required – pay only for parts.



Easy-to-use thumb screws allow the end user to remove/replace modules

Stingray's modular design also allows for do-it-yourself on-site troubleshooting. You can simply swap modules between workstations to isolate for testing and to verify functional status. Or swap modules from low volume workstations to higher volume down workstations to minimize impact to your restaurant – all without a technician or service contract.

unsurpassed quality testing ensures durability

Panasonic uses tough quality control and durability tests to ensure each Stingray workstation will stand up to the rigors of everyday use in the field. Every Panasonic workstation is purpose built for the restaurant environment, and they're known to last over 15 years – a testament to strict quality control.

With nearly 30 years in the industry, Panasonic has vast experience gained from designing, engineering and supporting multiple generations of Point of Sale solutions. All reflected in the quality, durability, convenience and intelligence built into every Stingray – and giving you the power to change.



Stingray is doused to test water resistance



Panasonic ideas for life

1.877.726.2767 • possales@us.panasonic.com • www.panasonic.com/stingray